

SECTION: PIC Breach Spillway #2
(Scale - 1:100 @ A0)

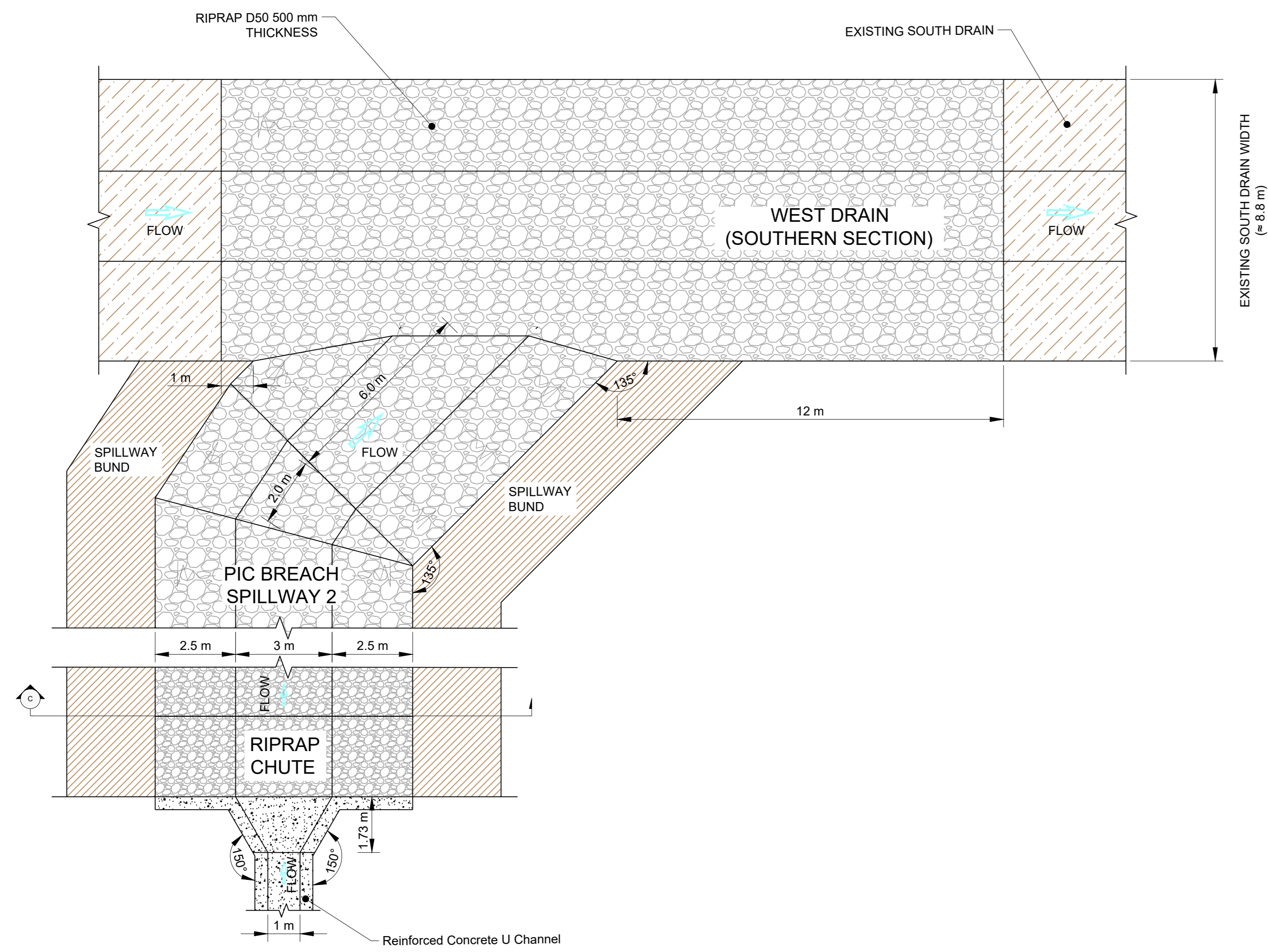

PLAN: Confluence with West Drain and Transition from Concrete U Channel to Rip-Rap Chute
(Scale - 1:100 @ A0)

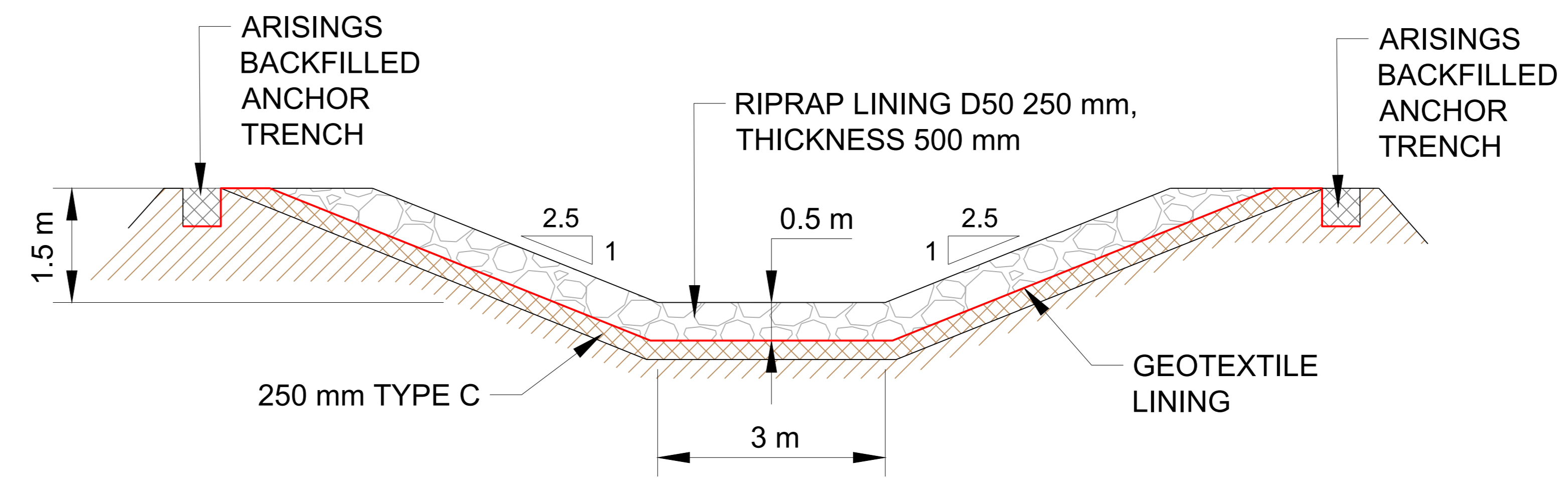

SECTION C: Rip Rap Chute
(Scale - 1:50 @ A0)

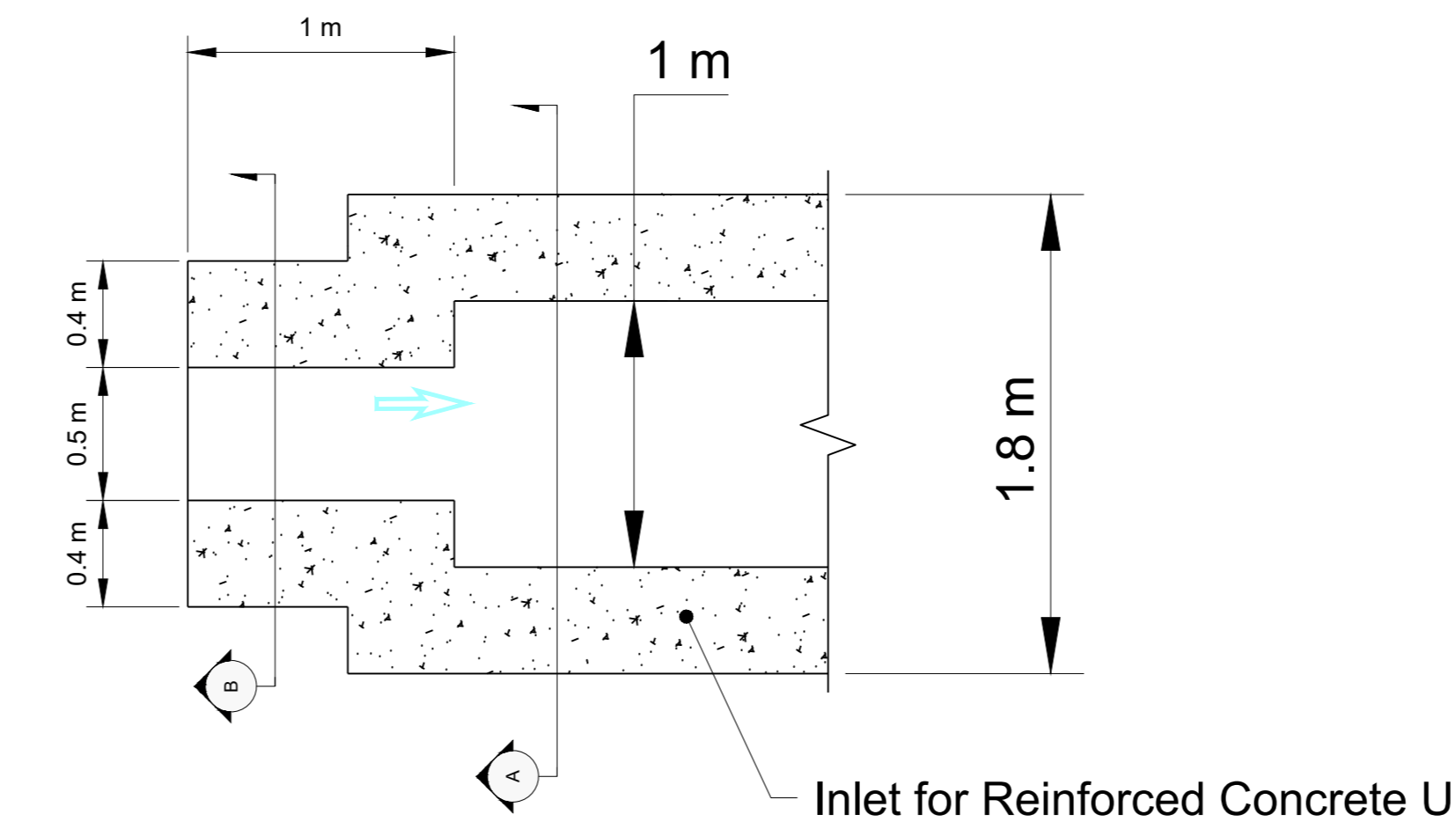

PLAN: Reinforced Concrete U Channel Inlet
(Scale - 1:25 @ A0)

REINFORCED CONCRETE U-CHANNEL RETAINING WALL NOMINAL THICKNESS 400 mm

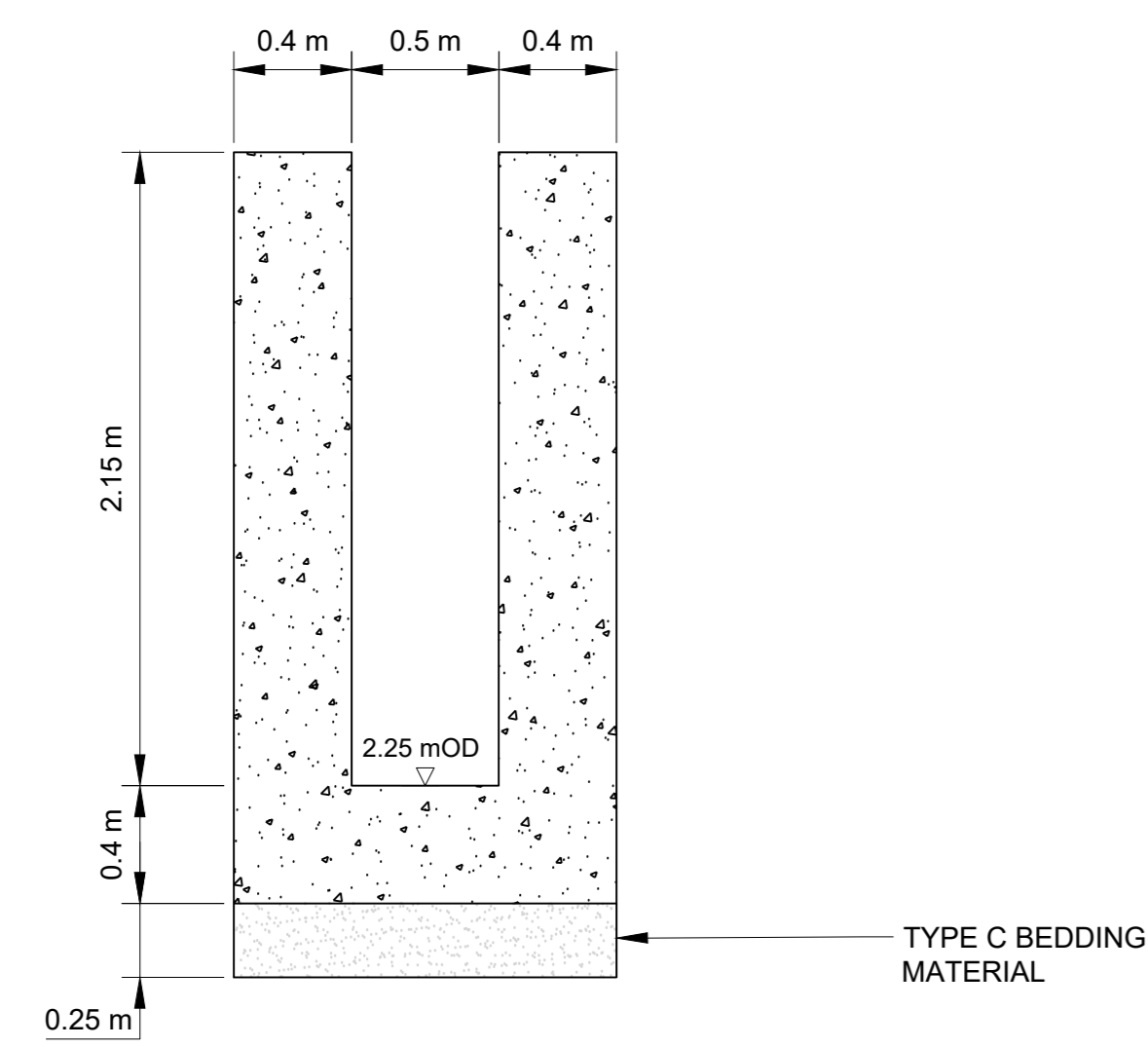

SECTION A: Reinforced Concrete U Channel Inlet
(Scale - 1:25 @ A0)

REINFORCED CONCRETE U-CHANNEL RETAINING WALL NOMINAL THICKNESS 400 mm

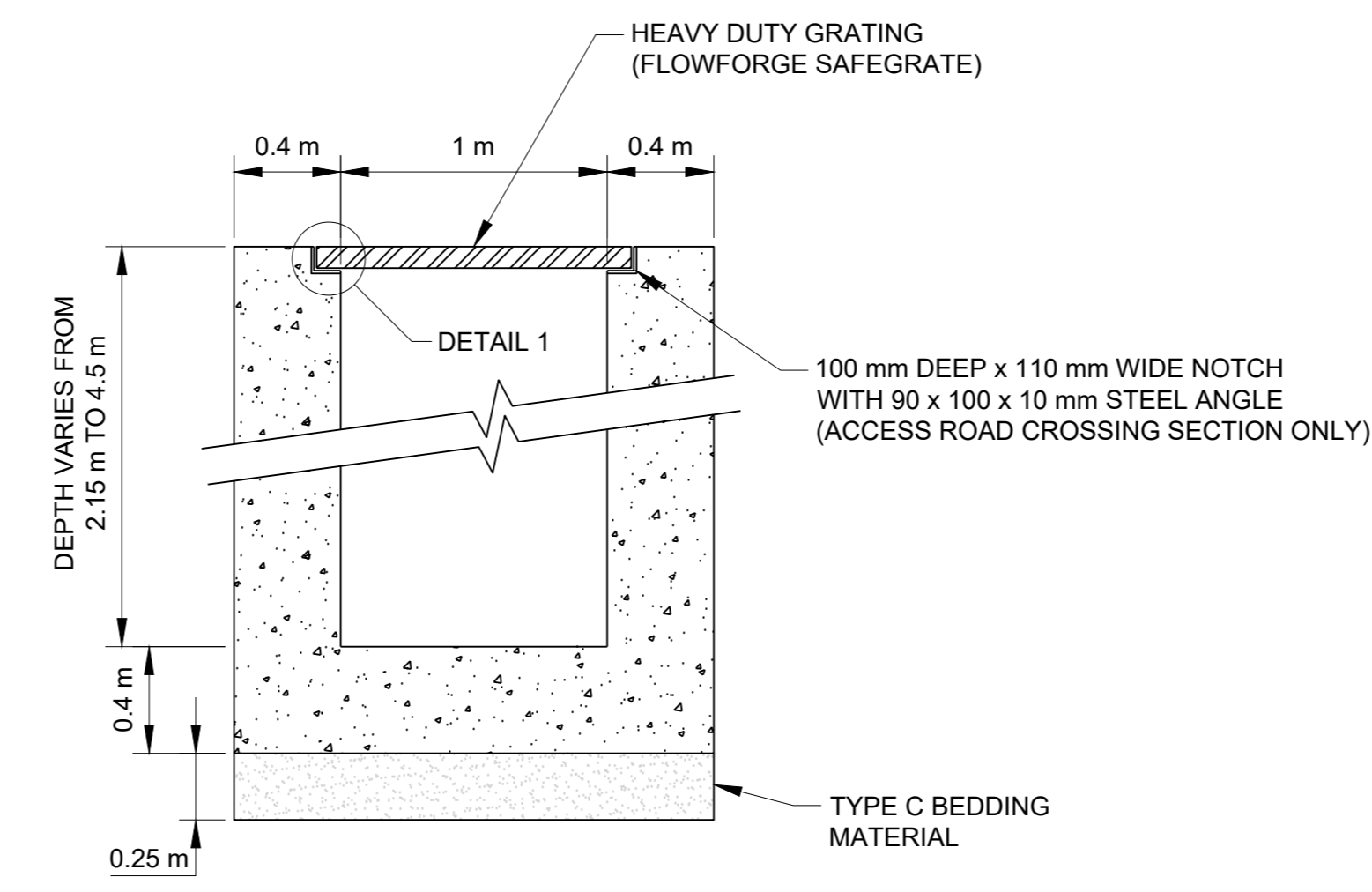

SECTION B: Reinforced Concrete U Channel
(Scale - 1:25 @ A0)

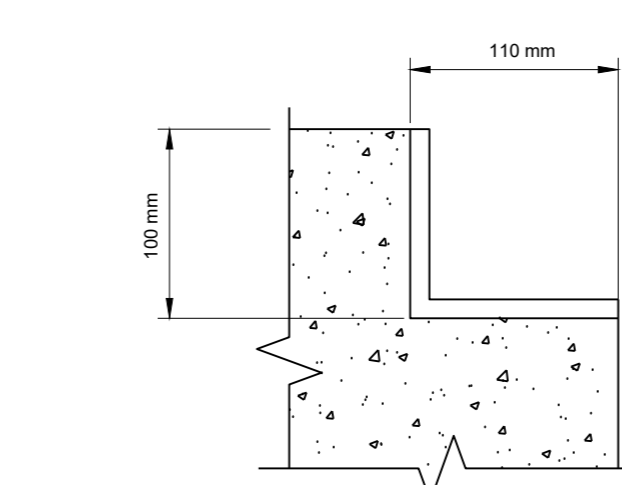

DETAIL 1: Notch for Grating
(NTS)

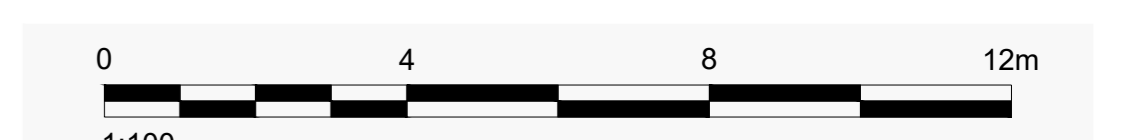
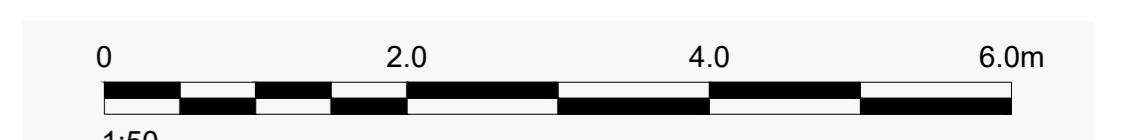
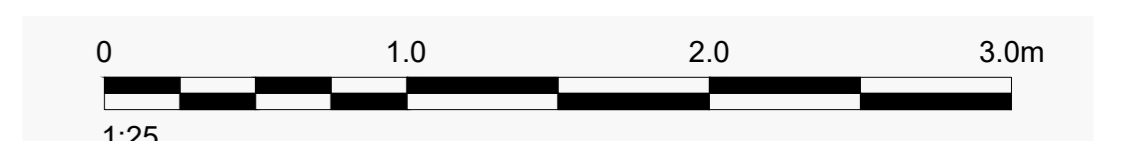

CLIENT

AUGHINISH ALUMINA LTD.

CONSULTANT



YYYY-MM-DD 2021-Nov-30

DESIGNED BK

PREPARED POB

REVIEWED BK

APPROVED BK

PROJECT

BRDA RAISE PLANNING APPLICATION DRAWINGS

TITLE

BRDA Details - Closure: PIC Breach Spillway #2
(See Drawing 10 for PIC breach locations)

PROJECT NO. 20143076

DRAWING NO. 12h

REV. A

SCALE 25 50 100 A0